

GAY STREET RECONFIGURATION PROJECT

Harrisonburg, Virginia

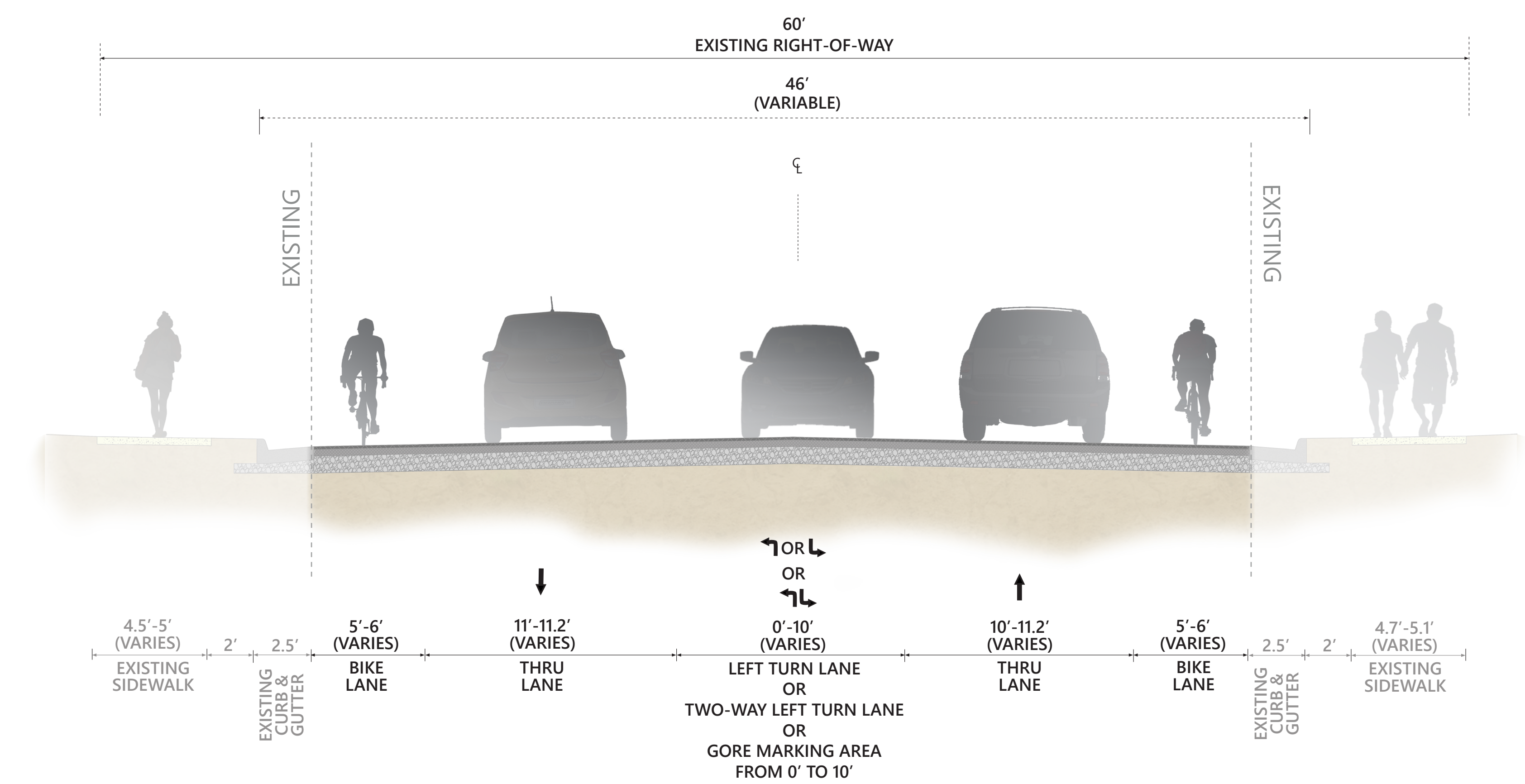

Typical Section Proposed Gay Street
NOT TO SCALE

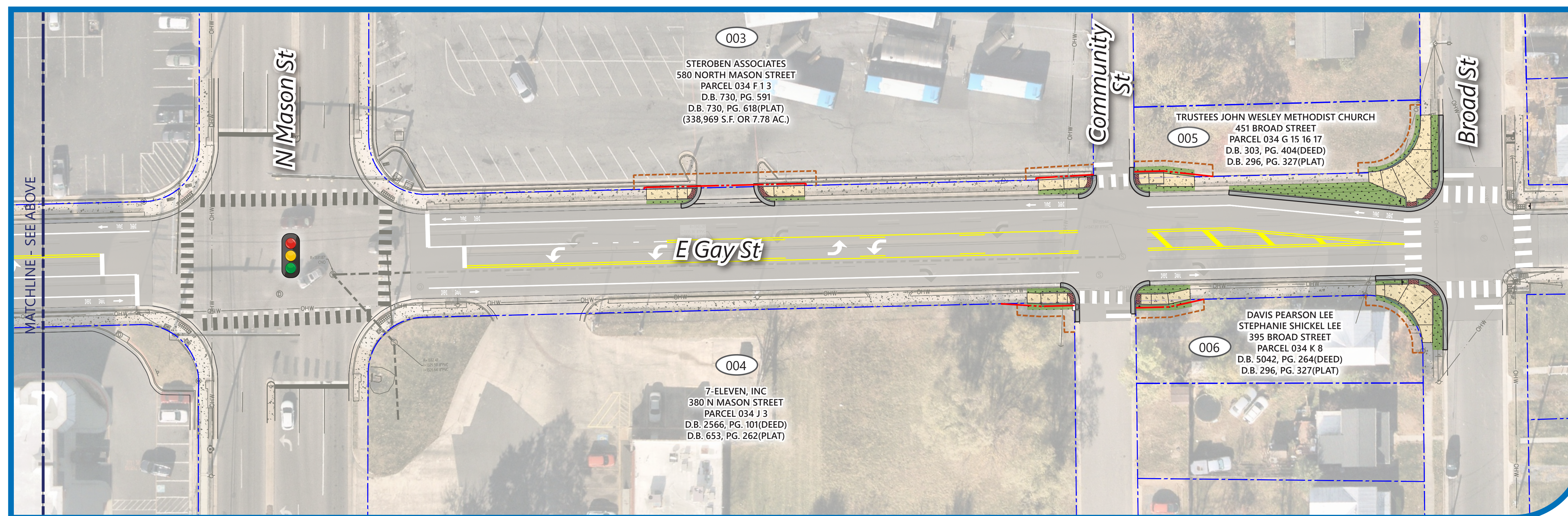
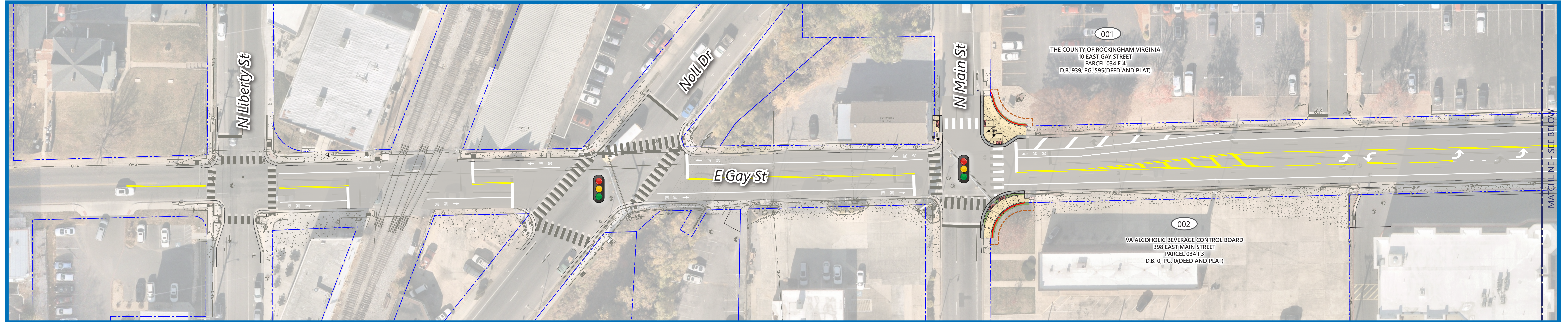
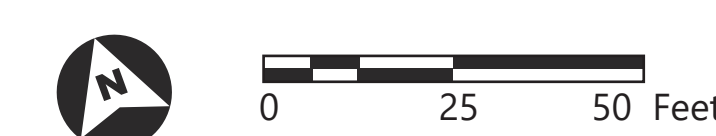

Source: City of Harrisonburg GIS, Nearmap.



LEGEND

- Existing Property Lines
- Proposed Right-of-Way
- Temporary Construction Easement
- Proposed Concrete/Sidewalk
- Proposed Detectable Warning Surface
- Proposed Curb & Gutter
- Proposed Greenspace
- Proposed Storm Structure
- Proposed Pedestrian Signal with Push Button